

***ATTACHMENT A***

***Product Drawings***

TEST SPECIMEN COMPLIES  
WITH THESE DETAILS.  
ANY DEVIATION IS NOTED.  
TEST COMPLETE: 12/4/07  
NCTL-110-10700-01

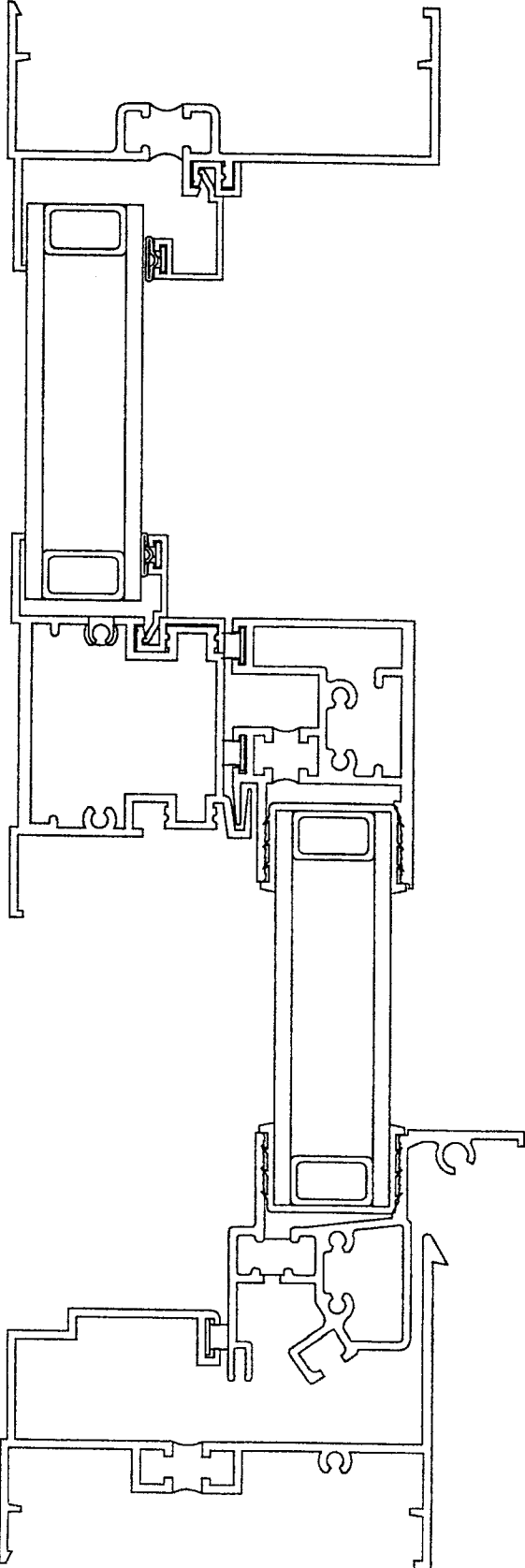

TEST SPECIMEN COMPLIES  
WITH THESE DETAILS.  
ANY DEVIATION IS NOTED.  
TEST COMPLETE: 12/4/07  
NCTL-110-10700-01

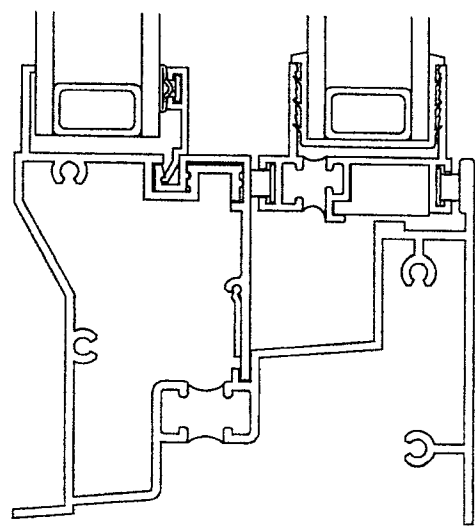
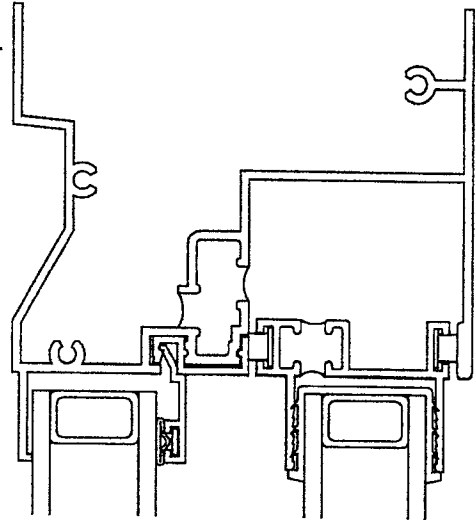



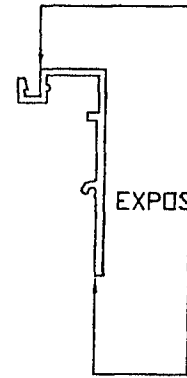
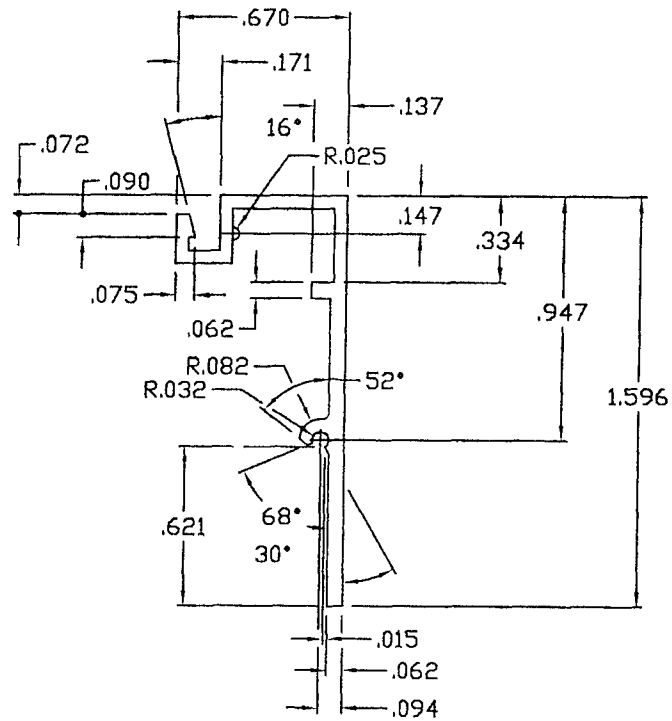

ACTUAL SIZE

- NOTES:
- 1) UNSPECIFIED WALLS .050
  - 2) BREAK ALL CORNERS .015R.
  - 3) AREA .157IN.<sup>2</sup>
  - 4) #/FT. .098

| REVISIONS |  | DATE | DESCRIPTION | ZONE | REV |
|-----------|--|------|-------------|------|-----|
|           |  |      |             |      |     |

TEST SPECIMEN COMPLIES WITH THESE DETAILS. ANY DEVIATION IS NOTED. TEST COMPLETE: 12/4/07. NCTL-110-10700-01

|        |     |             |       |           |          |
|--------|-----|-------------|-------|-----------|----------|
| SERIES |     | DESCRIPTION |       | MATERIAL  |          |
| 6050   |     | T-BREAK     |       | RIGID PVC |          |
| SIZE   |     | DWG NO.     | COLOR | REV       |          |
| B      |     | 6083        | BLACK | -         |          |
| SCALE  | 2:1 | DWN         | PHM   | DATE      | 12/27/00 |



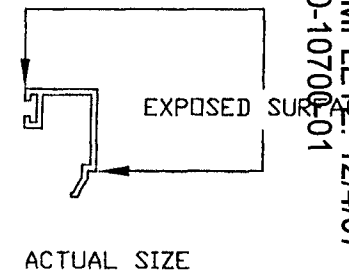
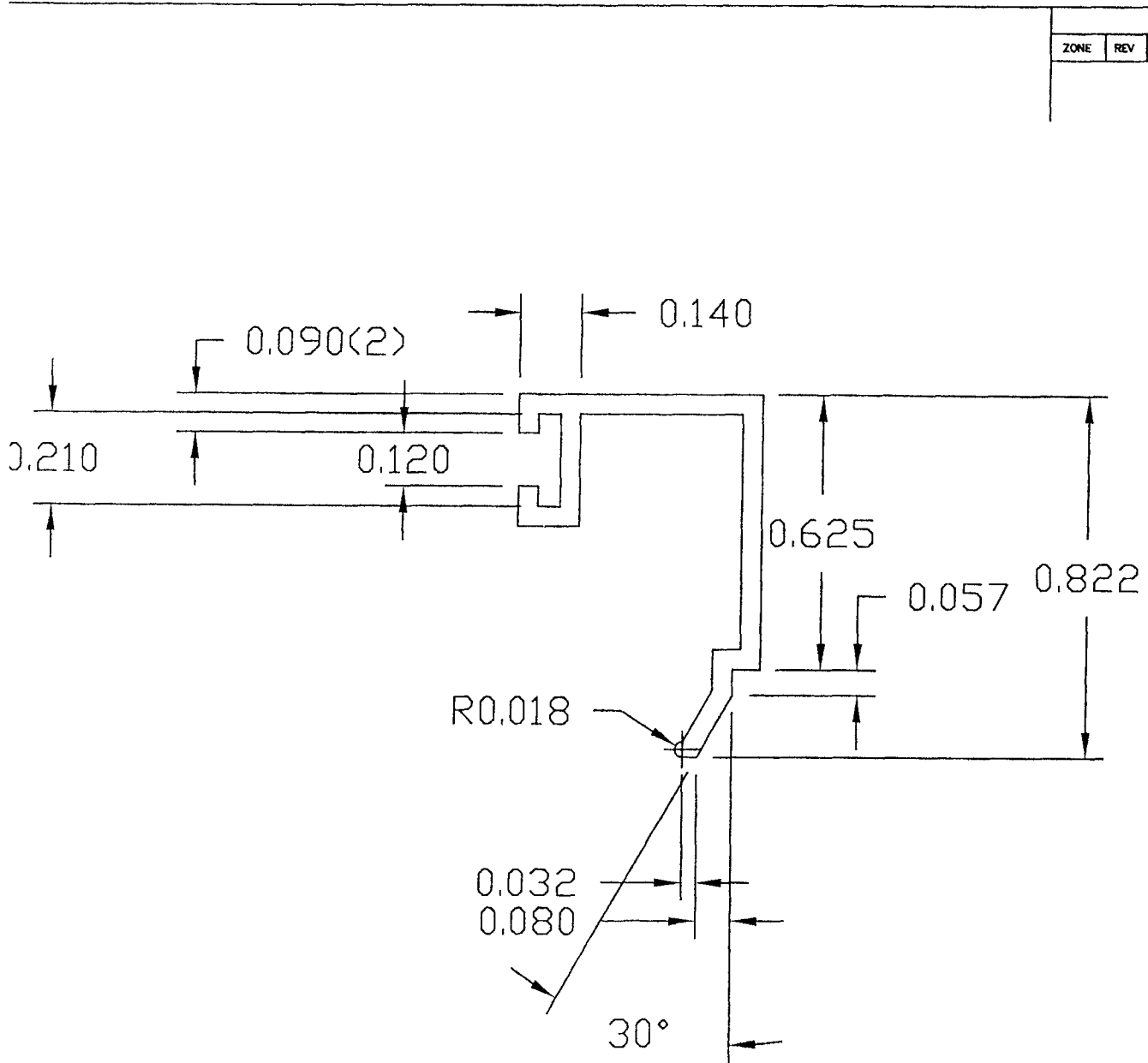

TEST SPECIMEN COMPLIES WITH THESE DETAILS. ANY DEVIATION IS NOTED. TEST COMPLETE: 12/4/07  
 NCTL-110-10700-01

| REVISIONS |     |             |      |
|-----------|-----|-------------|------|
| ZONE      | REV | DESCRIPTION | DATE |
|           |     |             |      |

- NOTES:
- 1) UNSPECIFIED WALLS .045
  - 2) BREAK ALL CORNERS .015R.
  - 3) AREA .084IN.^2
  - 4) #/FT. .104

|           |              |               |               |
|-----------|--------------|---------------|---------------|
|           |              |               |               |
|           |              |               |               |
| SERIES    | DESCRIPTION  | MATERIAL      |               |
| 6000      | GLAZING BEAD | 6063 T-5 ALU. |               |
| SIZE      | DWG NO.      |               | REV           |
| B         | 6062         |               | -             |
| SCALE 4:1 |              | DWN PHM       | DATE 12/11/00 |





SY-HS0615

DIE NUMBER

0.067

TEST SPECIMEN COMPLIES WITH THESE DETAILS. ANY DEVIATION IS NOTED. TEST COMPLETE: 12/4/07 NCTE-10-10700-01

RO.064 I.D  
RO.126 O.D

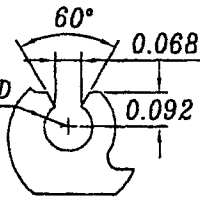

DETAIL "A"<sub>(2)</sub>  
SCALE 2:1

DETAIL "B"  
SCALE 3:1

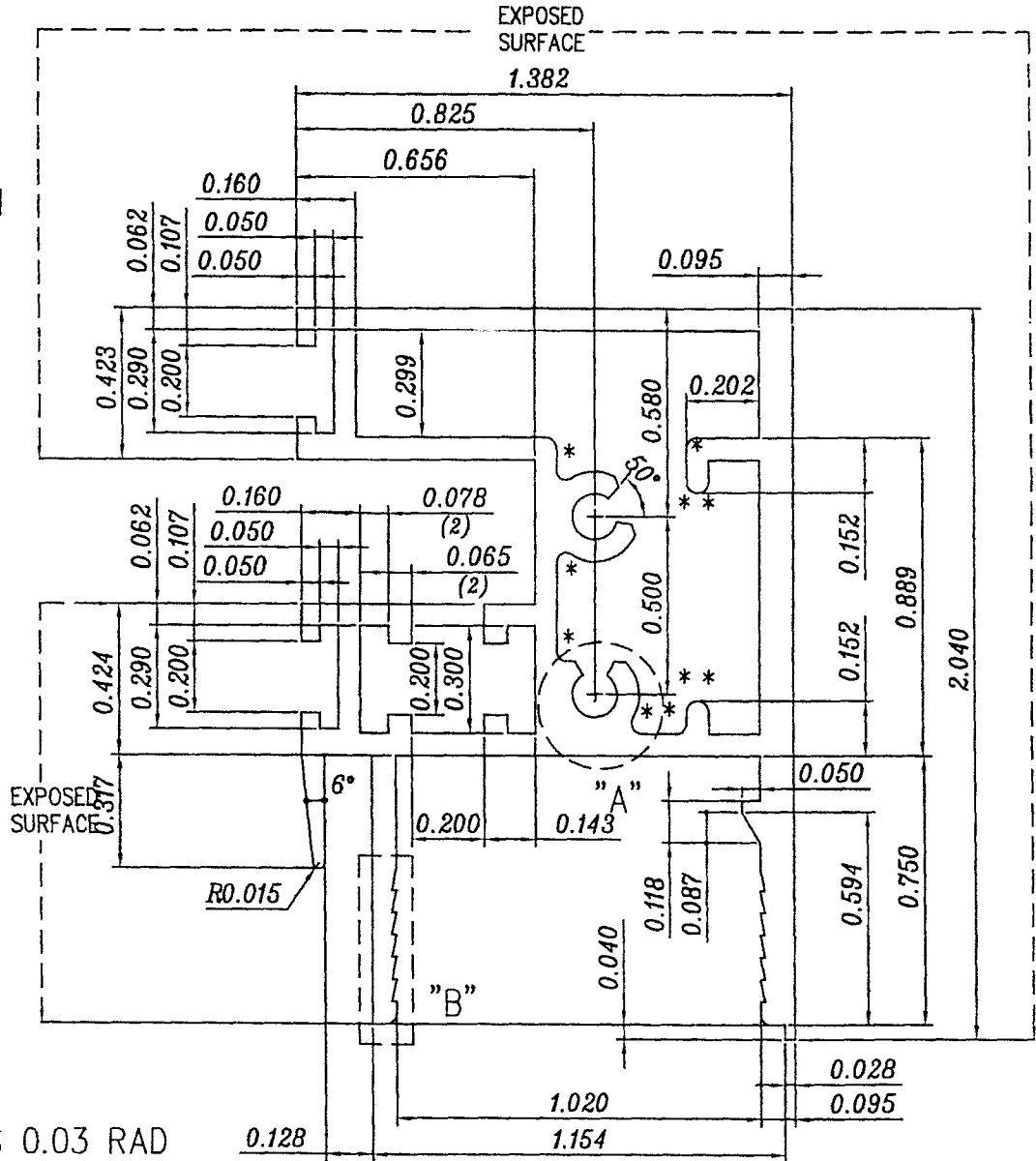

(\* ) DENOTES 0.03 RAD

ALL CORNERS 0.015 RADIUS UNLESS SPECIFIED UNSPECIFIED WALL THICKNESS 0.062 ALLOY/TEMPER 6063-T5

|   |                         |   |                      |
|---|-------------------------|---|----------------------|
| EST.AREA<br>0.680   | EST.PERIMETER<br>12.878 | FUJIAN SANYUAN METALS PRODUCTS CO.,LTD  |                      |
| EST.WT.PER FT.<br>0.843   | FACTOR<br>27            | CUSTOMER<br><b>HARRIS &amp; STANLEY</b> |                      |
| STANDARD TOLERANCES FOR EXTRUDED PRODUCTS APPLY UNLESS SPECIFICALLY SHOWN OTHERWISE |                         | DESCRIPTION                             | CIRCUMSCRIBED CIRCLE |
| REVISIONS   | DATE                    | SCALE<br>2:1                            | CUSTOMER NO.         |
|   |                         | DRAWN BY<br>???                         | DATE<br>30-12-2002   |
|   |                         | CHECKED BY                              |                      |

SY-HS0617

DIE NUMBER

TEST SPECIMEN COMPLIES WITH THESE DETAILS. ANY DEVIATION IS NOTED. TEST COMPLETE: 12/4/07 NCTL-110-10700-01

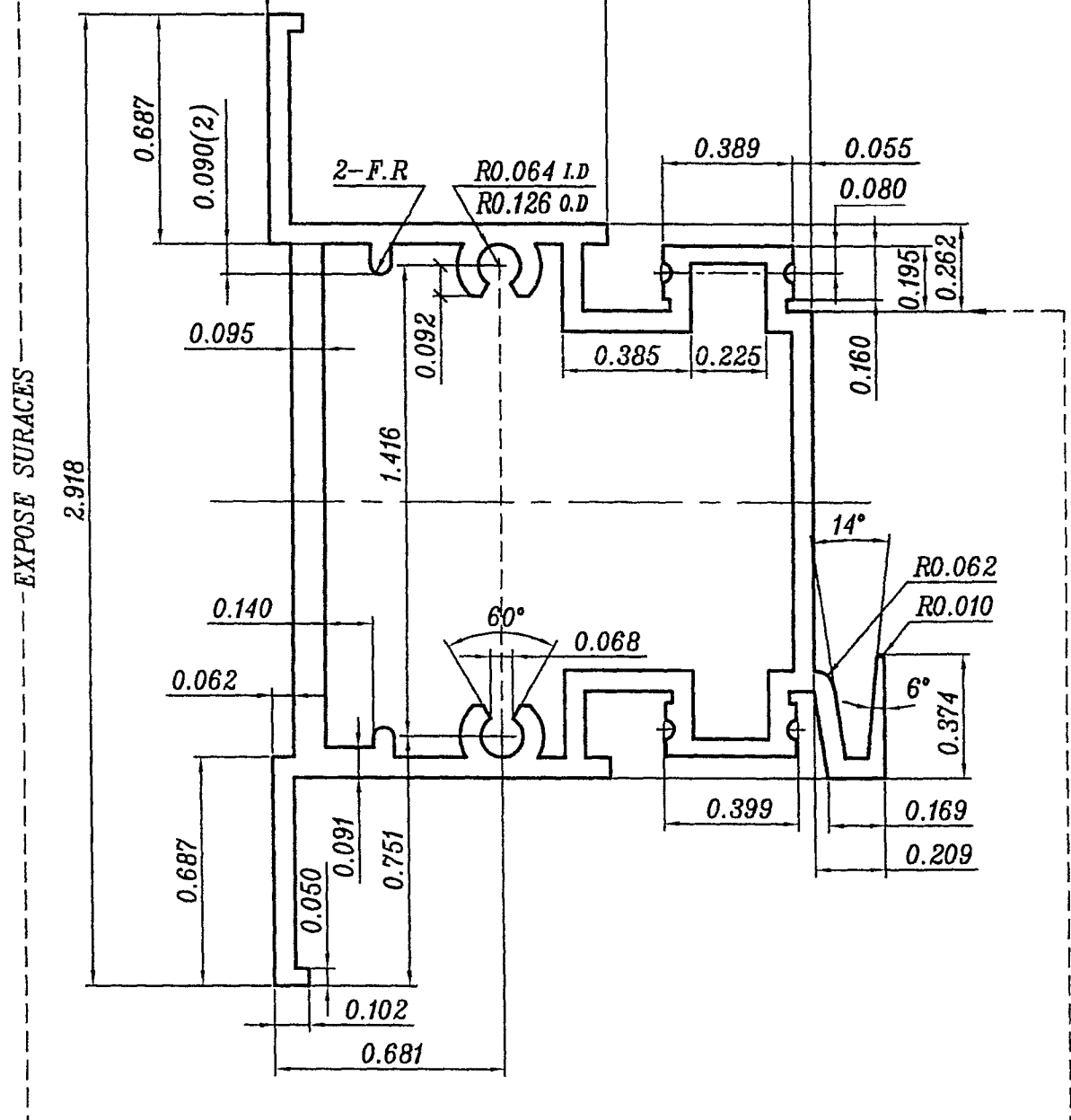

ALL CORNERS 0.015 RADIUS UNLESS SPECIFIED UNSPECIFIED WALL THICKNESS 0.062 ALLOY/TEMPER 6063-T5

|   |                          |   |                      |
|---|--------------------------|---|----------------------|
| EST. AREA<br>0.678  | EST. PERIMETER<br>12.133 | FUJIAN SANYUAN METALS PRODUCTS CO., LTD |                      |
| EST. WT. PER FT.<br>0.840   | FACTOR<br>27             | CUSTOMER<br><i>HARRIS &amp; STANLEY</i> |                      |
| STANDARD TOLERANCES FOR EXTRUDED PRODUCTS APPLY UNLESS SPECIFICALLY SHOWN OTHERWISE |                          | DESCRIPTION                             | CIRCUMSCRIBED CIRCLE |
| REVISIONS   | DATE                     | SCALE<br>2:1                            | CUSTOMER NO.         |
|   |                          | DRAWN BY<br>???                         | DATE<br>30-12-2002   |
|   |                          | END USE CONF                            |                      |

SY-HS0616

DIE NUMBER

TEST SPECIMEN COMPLETE WITH THESE DETAILS ANY DEVIATION IS NOTED TEST COMPLETE 12/4/07 RCTL-110-10700-01

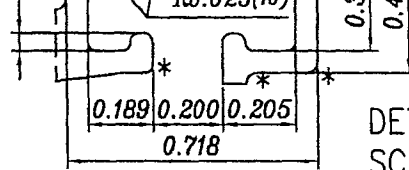

DETAIL "B"  
SCALE 2:1

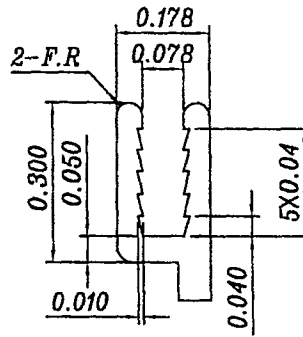

DETAIL "A"  
SCALE 3:1

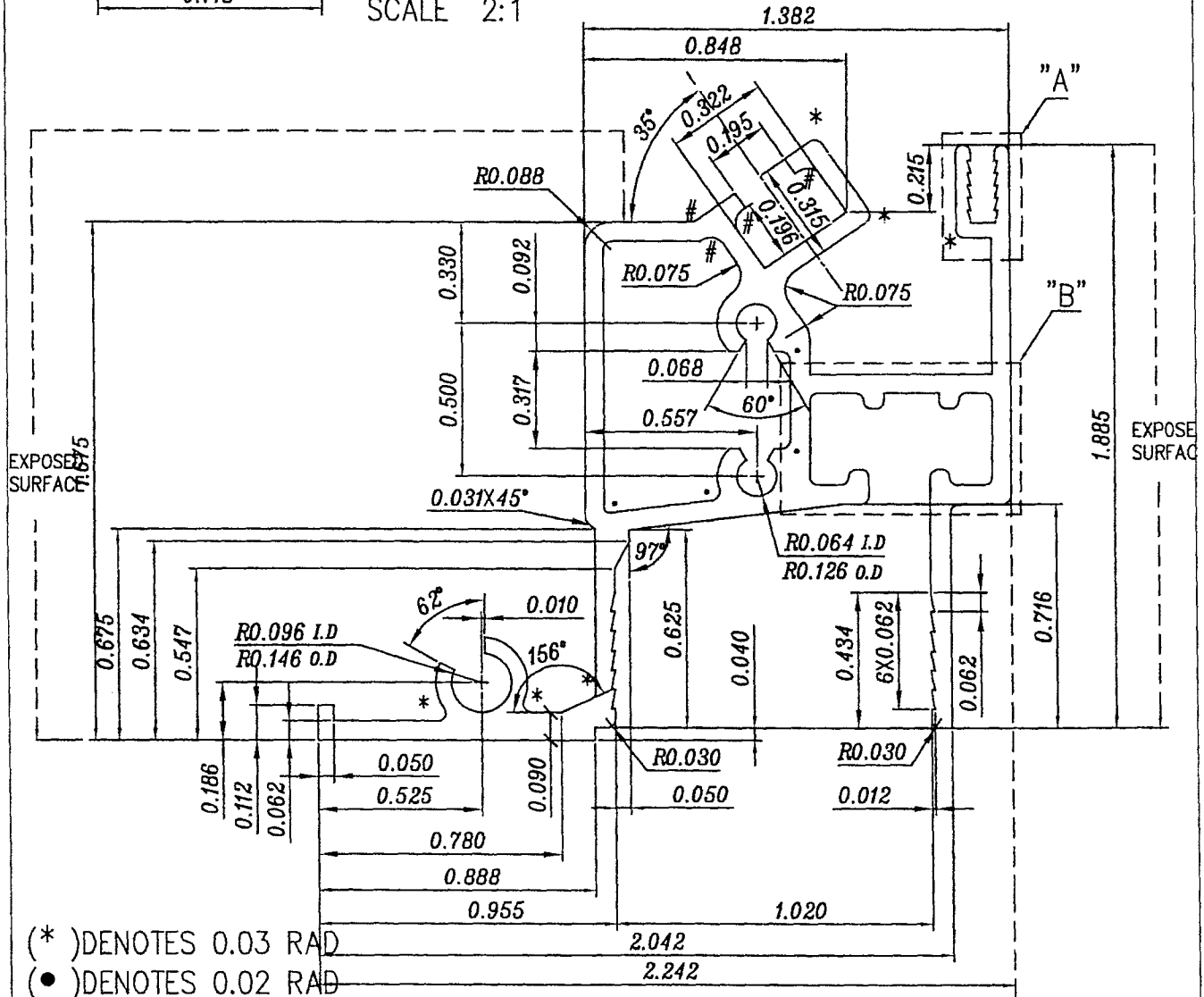

(\* ) DENOTES 0.03 RAD  
(• ) DENOTES 0.02 RAD  
(# ) DENOTES 0.05 RAD

ALL CORNERS 0.015 RADIUS UNLESS SPECIFIED

UNSPECIFIED WALL THICKNESS

0.062

ALLOY/TEMPER 6063-T5

|   |                          |   |                      |
|---|--------------------------|---|----------------------|
| EST. AREA<br>0.601  | EST. PERIMETER<br>15.429 | FUJIAN SANYUAN METALS PRODUCTS CO., LTD |                      |
| EST. WT. PER FT.<br>0.745   | FACTOR<br>27             | CUSTOMER<br><b>HARRIS &amp; STANLEY</b> |                      |
| STANDARD TOLERANCES FOR EXTRUDED PRODUCTS APPLY UNLESS SPECIFICALLY SHOWN OTHERWISE |                          | DESCRIPTION                             | CIRCUMSCRIBED CIRCLE |
|   |                          | REVISIONS                               | DATE                 |
| SCALE<br>2:1  | DRAWN BY<br>???          | DATE<br>30-12-2002                      | CUSTOMER NO.         |

